



SKU:SLAP10W202

SL202

OWNER'S MANUAL

AIR PURIFIER





Thank you for buying this **Air Purifier!**
Please read this manual carefully before using the product.

WARNING

In order to prevent harm or damage happened to users or others, be sure to comply with the requirement as below:

READ AND SAVE THESE INSTRUCTIONS

-  **Warning** It reminds that misusing or mishandling may cause death.
-  **Attention** It reminds that misusing or mishandling may cause hurt.



FORBID



FORCE

IMPORTANT SAFEGUARDS

Do plug the power into the socket completely.

It may cause fire because of heating or electrical shocking.
Do not use the damaged plug or loose socket.



Avoid any water on the surface of the unit.

It may cause short circuit or electrical shocking.



IMPORTANT SAFEGUARDS

WARNING

Please supervise your children and avoid them from touching or using machine



Do not connect or disconnect the power with wet hand
It may cause electrical shocking.



The appliance must be disconnected from the supply mains before cleaning or other maintenance.

Otherwise, the unit may start working in a sudden which may cause electrical shocking or hurt.



Do not insert any metal objects into the unit.

It may cause hurt or electric shocking.

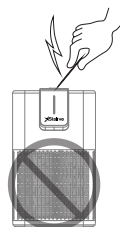

Do no disassembly, repair or reconstruct.

It may cause fire or damage.

Please contact the seller for replacement.



Do not use over-limit sockets or wiring connectors. Please use the rated voltage.
It may cause a fire.



Do not repair it when the cord or plug is damaged.

It may cause short circuit, electric shocking or fire.

Please contact the retailer for replacement.



If there is dust on the plug, it may weaken the insulation, even cause fire.

Take out the plug and clean it with dry cloth. Please remove the plug from the socket if not using for a long period.



IMPORTANT SAFEGUARDS

Do not use in the room with a gas stove.

It may cause hurt because the machine is not a ventilator.

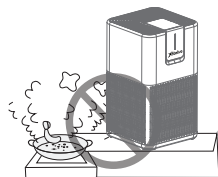

Do not place the unit near fires.

It may cause fire.

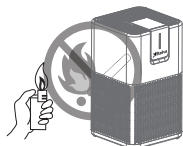

Do not use in the watery or high temperature room such as the bathroom etc.

Otherwise, it creeps, electric shocking or fire.

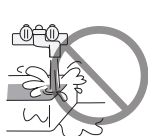

Please hold the plug instead of the cord when unplugging the power.

Otherwise, it may cause short circuit, breaking of the cord, electric shocking or fire.

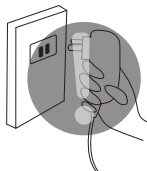

Keep away from alcohol organic impregnant.

It may cause cracking, short circuit electric shock injury or fire

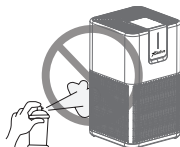

Please ventilate timely when used with fire in the room.

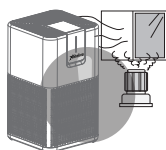

Please remove the plug from the socket if any conditions as below:

- If all switches do not work
- If the power cord or plug hot singularly
- If any peculiar smell, exceptional noise or vibration
- Any other abnormality or failure

ATTENTION

If the power cord is , please send it to the retailer or service centre or technician for repairing. Do not change or repair it by yourself.

WARN THE USER TO UNPLUG OR DISCONNECT THE APPLIANCE FROM THE POWER SUPPLY BEFORE SERVICING.

⚠ Warning

To Reduce The Risk Of Fire Or Electric Shock, Do Not Use This Fan With Any Solid-State Speed Control Device

⚠ Warning

To Reduce The Risk Of Fire, Electric Shock Or Injury To Persons, Do Not Use Replacement Parts That Have Not Been Recommended By The Manufacturer (e.g. Parts Made At Home Using A 3D Printer).

PRODUCT TECHNICAL FEATURES

PURIFICATION TECHNOLOGIES

The multi-functional filter is composed of pre-filter, HEPA layer and activated carbon layer.

AIR PURIFICATION PROCESS

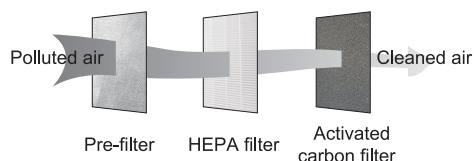

PRODUCT INTRODUCTION

APPEARANCE DIAGRAM

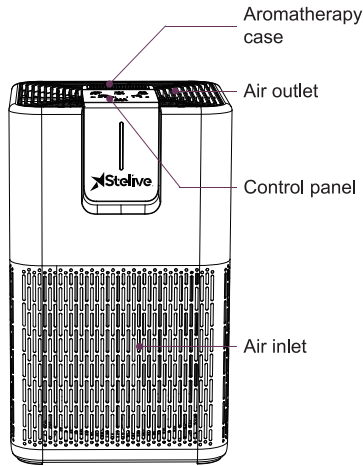

DECOMPOSITION DIAGRAM

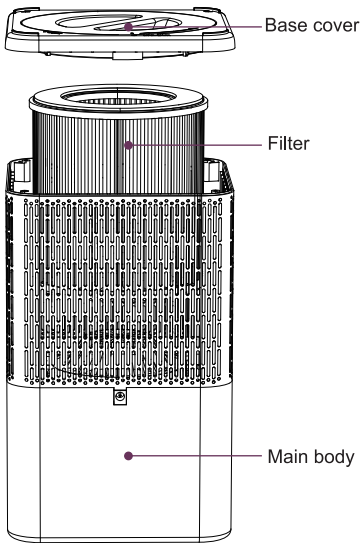

SPECIFICATIONS

Rated Power	10 W
Air flow rate	105 m³/h
Net weight	1.5 kg
Voltage	12V DC
Noise Level	13~50 dB(A)
Area Coverage	30 m²
Dimension	17x17x28.5cm

PARTS TO INTRODUCE

DIAGRAM OF CONTROL PANEL

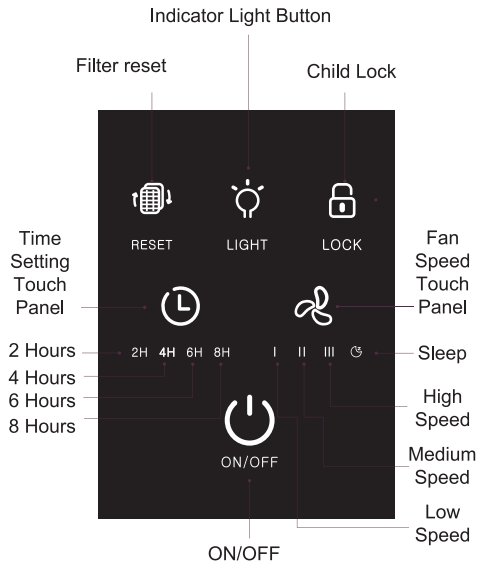

OPERATION INSTRUCTIONS BEFORE USE

PLACEMENT

Make sure the appliance is placed at least 30cm away from any wall or piece of furniture. Do not position the air purifier directly under furniture or objects that may obstruct the exhaust air flow.
Do not use the appliance near any source of heat.

REPLACE THE FILTER

Replace the filter and reset.

The filter replacement indicator will light up when cumulative running time reaches 1440hrs. replace the filter with a new one. Then, press and hold the reset button for approximately 3 seconds to reset the filter's lifetime counter, and the filter replacement indicator will turn off.

INSTALL THE FILTER

1. Please remove the new filter protective film before installation.
2. Rotate the base cover clockwise properly until the filter is installed securely.

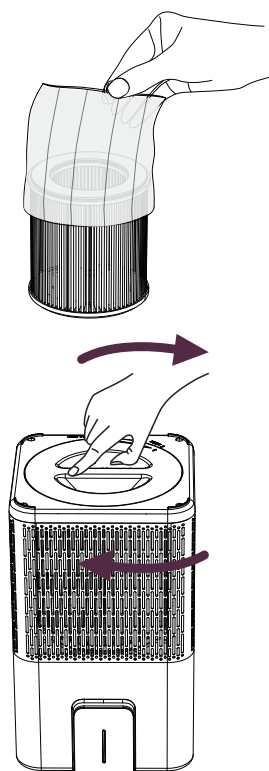

EXTERNAL POWER SUPPLY

DC Adaptor

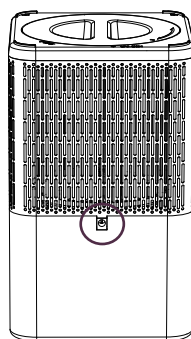

Machine socket



Adaptor

- Please do not mistakenly connect the external power source different from the power adaptor specification of this machine, and firmly insert the plug into the power socket.
- Connect the power, the power adaptor DC plug into the machine's DC socket, and then plug the power adaptor into the ac socket.
- When power is cut off, first unplug the ac plug of the power adaptor, and then unplug the DC plug from the unit

AROMA

A replaceable aroma pad is included in the aroma tray on the top outlet, where you can put a few drops of essential oil (not included) This allows you to breathe in fresh air and relax yourself!

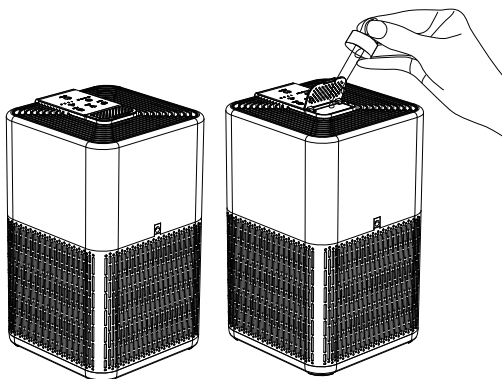

INSTRUCTIONS FOR USE

THE POWER SETTING

- After power-on the machine emits a beep sound for about 1 second, all lights on the display screen are on for self-check. After the self-inspection is completed, all the displays are off and enter the stand by mode.
- In standby mode, touch the top power switch to turn on, the wind speed key is on by default after power on, and the low speed indicator is on. The fan runs at low speed and the atmosphere light is on. Touch the top power switch again to turn off and the machine enters the standby mode.

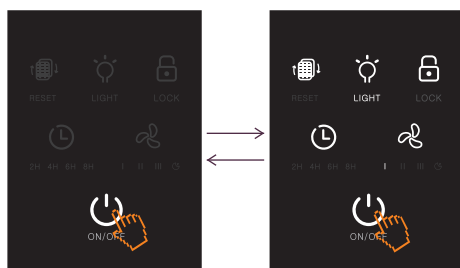

Standby Mode

Power-on default state

CHILD LOCK SETTING

Press and hold the LOCK Button for 3 seconds to enter the child lock state. The child lock light is on, and all buttons are invalid. Press and hold the LOCK button again for 3 seconds to exit the child lock state, and all buttons will resume normal functions.

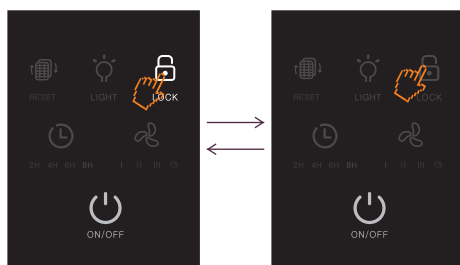

Child Lock On

Child Lock Off

FAN SPEED SETTING

When entering sleep mode, all lights will be automatically switched off, except for the sleep mode indicator light, if there is no operation within 10 seconds, Deactivate sleep mode by pressing any button.

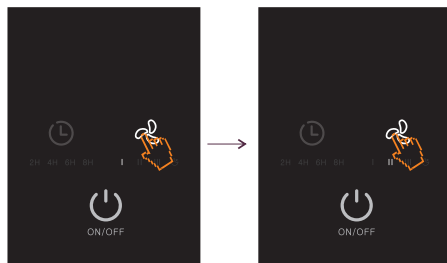

low fan speed

Medium fan speed

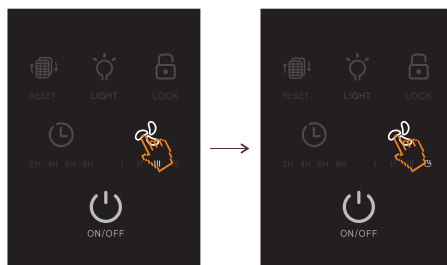

High fan speed

Enter into sleep mode

TIME SETTING

Touch Time Setting Panel to Setting Time.

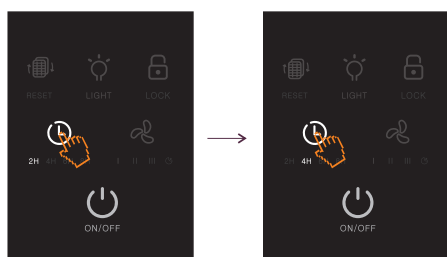

Time Setting for 2 Hours

Time Setting for 4 Hours

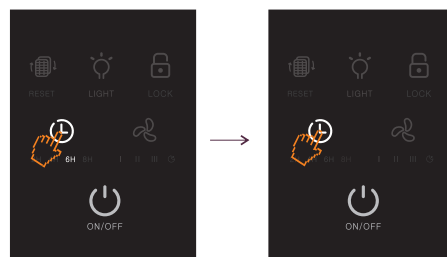

Time Setting for 6 Hours

Turn off time setting

FILTER REPLACEMENT INDICATOR

The filter reminder lights up, indicates it is time to replace the filter.
Remove the plastic bag of the new filter and install the filter correctly. Press the filter reminder button for 3 seconds to reset the machine.

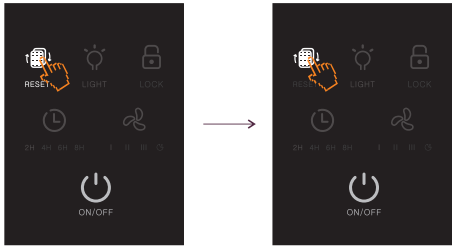

The indicator light is on

The indicator light is off

INDICATOR LIGHT BUTTON

Press this button to switch on/off the ambient light mode.
Air purifiers with light have a multi-sensory effect to soothe your mind and body.

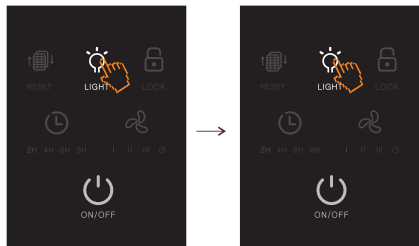

Turn on all the lights

The indicator light is off

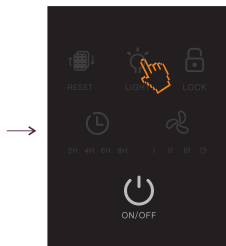

Turn off all lights

CLEANING AND MAINTENANCE

Maintenance and cleaning methods



Please remove adaptor from the socket before cleaning and maintenance.



- Cleaning the body of this device by damp cloth, then wipe it dry.
- If the machine is too dirty, neutral detergent can be used for cleaning, but please dilute the detergent before use.
- Do not clean the unit with the solvent listed on the right which may cause distortion or discolour.

TROUBLE SHOOTING

Problem	Checking methods	Possible solution
No Power Adaptor	Does not open the base cover to take out the adaptor?	Please open the bottom cover and take out the power adaptor.
Do not work	Please check if the plug of power adaptor is disconnected from the socket?	Power plug should be plugged properly
Odour can not be removed	Is there a very strong Odour in the using environment? (Notes: air should be purified continuously)	It is recommended to ventilate first and then turn on the machine
	Does the using life time for filters come to the end?	Please replace the used filter with a new one.
High noise	Is the PE bag for filter removed?	Please take out filter and tear off PE bag.
	Does the using life time for filters come to the end?	Please replace new filter

If the problem is still existed after above inspections, please disconnect the power and contact our customer for repair.

CARING FOR THE ENVIRONMENT



Power tools that are no longer usable should not be disposed of with household waste but in an environmentally friendly way. Please recycle where facilities exist. Check with your local council authority for recycling advice.



Recycling packaging reduces the need for landfill and raw materials. Reuse of recycled material decreases pollution in the environment. Please recycle packaging where facilities exist. Check with your local council authority for recycling advice.

WARRANTY

Your warranty form should be retained by you at all times. In order to make a claim under this warranty, you must return the product with your receipt of purchase. Prior to returning your product for warranty. Please contact us via our after sales support services.

EMAIL: support@topto.com.au

YEAR REPLACEMENT WARRANTY

Your product is guaranteed for a period of 12 months from the original date of purchase and is intended for DIY (Do It Yourself) use only. If a product is defective, it will be replaced in accordance with the terms of this warranty. Warranty excludes consumable parts, for example: driver bits.

WARNING

1. The following actions will result in the warranty being void.
Professional, Industrial or high frequency use.
2. If the tool has been operated on a supply voltage other than that specified on the tool.
3. If the tool shows signs of damage or defects caused by or resulting from abuse, accidents or alterations.
4. Failure to perform maintenance as set out within the instruction manual.
5. If the tool is disassembled or tampered with in any way.

How to get 1 extended year warranty?

This product comes with 1 year replacement warranty. However, you may get 1 extra year warranty with conditions. Please ask for detail by sending an email to **support@topto.com.au**



**CUSTOMER SERVICE
& PARTS**

Contact: support@topto.com.au